

ACCOSATO

THROTTLE CONTROL DATA SHEET



Accossato Throttle Control are CNC worked in aluminium alloy.

In the 2-cable Throttle Controls kit (except from those fitting BMW) you will find 3 CAMs with three diameters: 40 mm – 43 mm – 45 mm

In the kit of the specific Throttle Control for BMW you will find one CAM with a diameter of 47mm.

With three CAMs you can adjust the Throttle Control, making it quicker or slower: **with a bigger diameter of the CAM, you will have a quicker Throttle Control (reduced rotation of the grip).**

Throttle control replacement

- Before dismantling the throttle control, take off the parts of the motorcycle that may impede the passage of the tools and / or the mounting of the throttle control (fairing, fuel tank, etc...)
- Select the CAM in aluminium that better fits your racing style

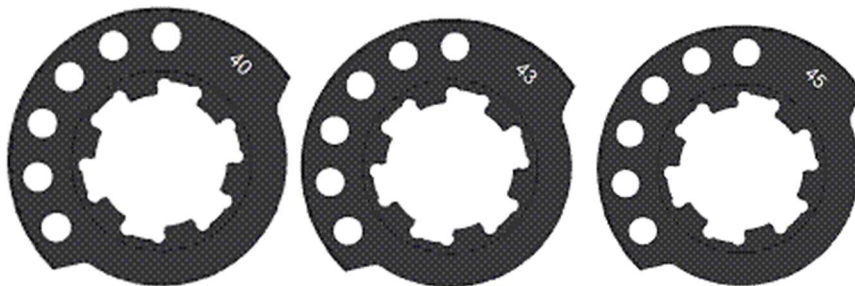

- Insert the CAM on the tube. Press until the bottom in order to have the surface of the CAM and the tube on the same level.

ACCROSSATO

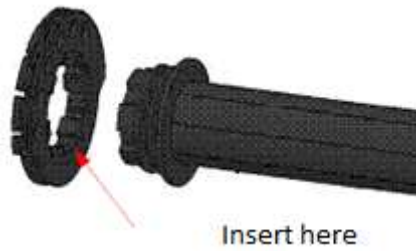

- Connect the two cables of the throttle control to the lower half knob, make sure you insert the forward and backward cables correctly.



Please note: On the forward cable you will find a code starting by: T040.XXXXXXX
On the backward cable you will find a code starting by: T050.XXXXXXX

- Tighten the two cables to the lower knob with a wrench
- Pull out the cables in steel from inside the lower half knob to ease the insertion on the CAM
- Connect the cables in steel of the Throttle Control forward and backward of the CAM
- Mount the upper knob and partially tight the screw

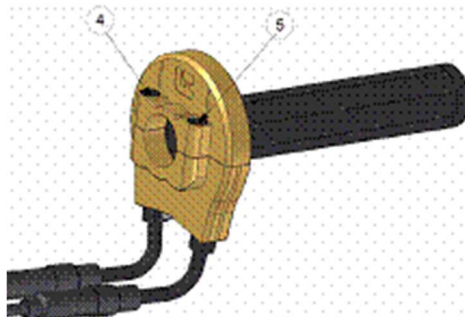

Caution: for a proper assembly we recommend to tight the screw in alternance: after getting them close manually, tight the screw with a wrench (4) completing a half turn, then take the other screw (5) and complete an half turn 5(. Repeat until you get 10 Nm MAX on both screws.

- Proceed with the installation of the forward and backward cables on the gas valve.

ACCROSSATO

-
- Proceed with the registration of the cables and verify the correct mounting of the throttle controls.