



848 2008-2013

FITTING INSTRUCTIONS TO BE FITTED BY A QUALIFIED TECHNICIAN



THIS SHEET INCLUDES FITTING INSTRUCTIONS FOR THE FOLLOWING PARTS:

Secondary Alternator Cover Part No. EC-1198-2007-1-GBR / Secondary Clutch Cover Part No. EC-848-2008-2-GBR

Secondary Oil Inspection Cover Part No. EC-1198-2007-4-GBR / Secondary Water Pump Cover Part No. EC-1198-2007-5-GBR



SECONDARY ALTERNATOR COVER PART NO. EC-1198-2007-1-GBR

Will also fit RACE ONLY models: 748 / 749 / 916 / 996 / 998 / 999

- 1 Remove fairing.
- 2 Remove 3 existing bolts from the stock Alternator cover, shown as position Bolt 1, 2 & 3.
- 3 Place the Secondary Alternator Cover over the stock cover.
- 4 Assemble 3 replacement bolts loosely in the correct position as shown.
Note: Must use thread lock
- 5 Tighten bolts to a Torque of 8Nm as per Manufacturer's recommendations.
DO NOT OVERTIGHTEN.
- 6 Re-Fit Fairing.

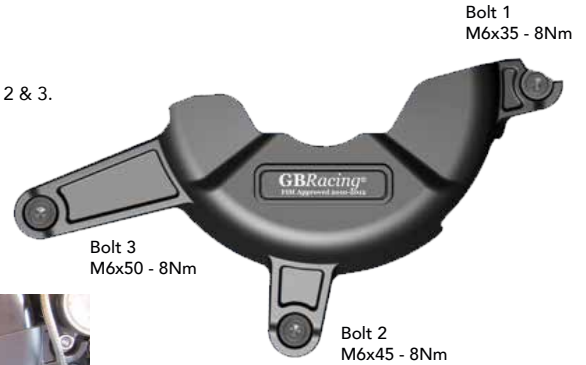
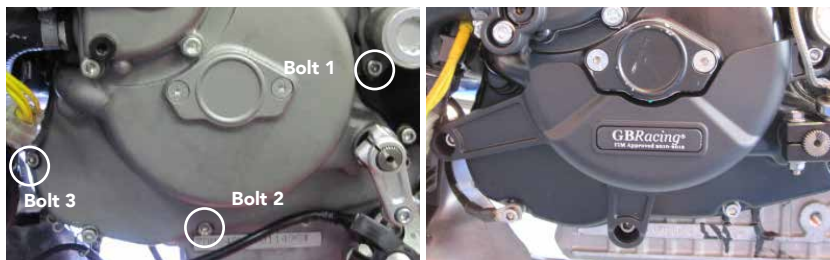

SECONDARY CLUTCH COVER PART NO. EC-848-2008-2-GBR

Will also fit RACE ONLY models: 748 / 749 / 916 / 996 / 998 / 999

- 1 Remove 4 existing bolts from the Clutch cover, shown as position Bolt 1, 2, 3 & 4.
- 2 Place the Secondary Clutch Cover over the stock cover.
- 3 Assemble 4 replacement bolts loosely in the correct position as shown. Note: Must use thread lock
- 4 Tighten bolts to a Torque of 8Nm as per Manufacturer's recommendations.
DO NOT OVERTIGHTEN.

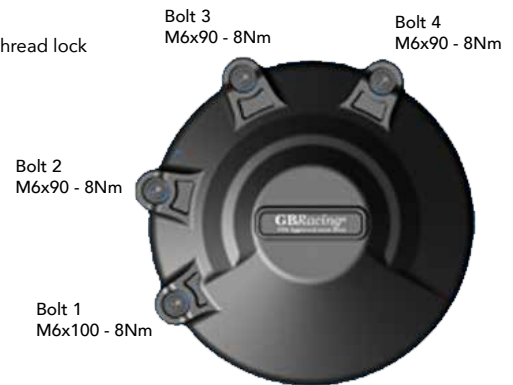
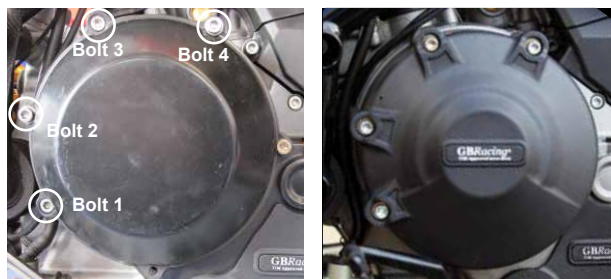

SECONDARY OIL INSPECTION COVER PART NO. EC-1198-2007-4-GBR

- 1 Remove Fairing
- 2 Remove 3 existing bolts from the Oil Inspection Clutch cover, shown as position Bolt 1, 2 & 3 (Replace bush at position 3 with SPB4 if overflow clamp assembly is present)
- 3 Place the Secondary Oil Inspection Clutch Cover over the stock cover. Assemble 3 replacement bolts loosely in the correct position as shown. Note: Must use thread lock
- 4 Tighten bolts to a Torque of 8Nm as per Manufacturer's recommendations. DO NOT OVERTIGHTEN.
- 5 Re-Fit Fairing

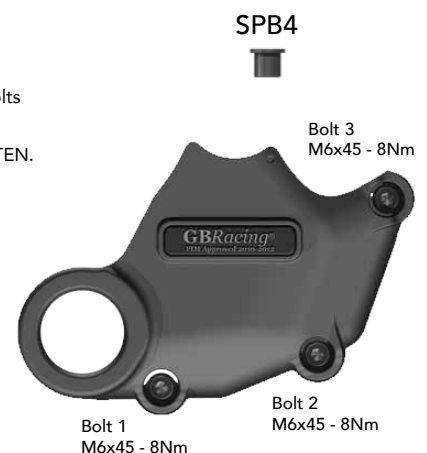
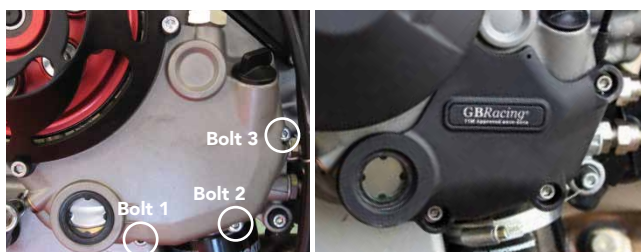



848 2008-2013

FITTING INSTRUCTIONS TO BE FITTED BY A QUALIFIED TECHNICIAN



SECONDARY WATER PUMP COVER PART NO. EC-1198-2007-5-GBR

Will also fit RACE ONLY models: 748 / 749 / 916 / 996 / 998 / 999 - see NOTE*

- 1 Remove 3 existing bolts from the Water Pump cover, shown as position Bolt 1, 2 & 3 (Retain washer at Bolt 2 position. Reuse this washer and add supplied washer either end of the St.Steel bush, See Fig.1).
If casing is not counterbored remove St.Steel bush at Bolt 2 position and replace with supplied SPB4 St.Steel bush.
- 2 Place the Secondary Water Pump Cover over the stock cover. Assemble 3 replacement bolts loosely in the correct position as shown. Note: Must use thread lock.
- 3 Tighten bolts to a Torque of 8Nm as per Manufacturer's recommendations.
DO NOT OVERTIGHTEN.

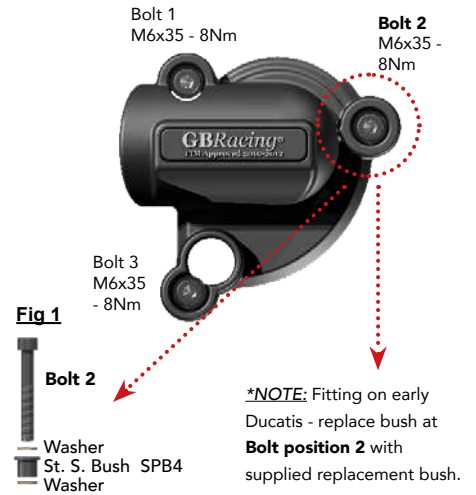
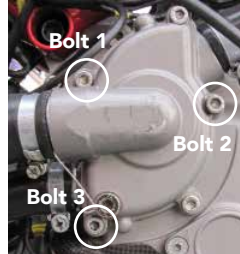

Engine Cover Set: EC-1198-2007-SET-GBR EC-1198-2007-1-GBR, EC-1198-2007-4-GBR, EC-1198-2007-5-GBR

www.GBRacing.eu

Engine Cover Set: EC-848-2008-SET-GBR

EC-1198-2007-1-GBR, EC-848-2008-2-GBR, EC-1198-2007-4-GBR, EC-1198-2007-5-GBR

DO NOT use these products unless you agree to our Terms & Conditions, as shown on our paperwork and website. If you do not agree, please return the product(s) to your dealer for a refund.