

BULLET FRAME SLIDER - LEFT HAND SIDE - STREET
PART NO. FS-ZX10-2011-LHS-S

- 1 Remove upper engine mounting bolt, located through the fairing opening.
- 2 Assemble bolt through the aluminium bush into correct position.
- 3 Tighten to 40NM torque.
- 4 Slide bullet moulding onto aluminium bush.
- 5 Screw M6 bolt into front of bullet moulding hand tight.



BULLET FRAME SLIDER - RIGHT HAND SIDE - STREET
PART NO. FS-ZX10-2011-RHS-S

- 1 Remove upper engine mounting bolt, located through the fairing opening.
- 2 Assemble bolt through the aluminium bush into correct position.
- 3 Tighten to 40NM torque.
- 4 Slide bullet moulding onto aluminium bush.
- 5 Screw M6 bolt into front of bullet moulding hand tight.

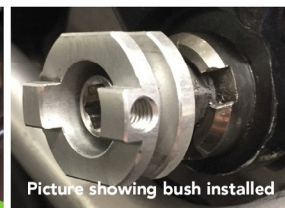

BULLET FRAME SLIDER - LEFT HAND SIDE - RACE
PART NO. FS-ZX10-2011-LHS-R

- 1 Remove upper engine mounting bolt, located through the fairing opening.
- 2 Assemble bolt through the aluminium bush into correct position.
- 3 Tighten to 40NM torque.
- 4 Slide bullet moulding onto aluminium bush.
- 5 Screw M6 bolt into front of bullet moulding hand tight.



BULLET FRAME SLIDER - RIGHT HAND SIDE - RACE
PART NO. FS-ZX10-2011-RHS-R

- 1 Remove upper engine mounting bolt, located through the fairing opening.
- 2 Assemble bolt through the aluminium bush into correct position.
- 3 Tighten to 40NM torque.
- 4 Slide bullet moulding onto aluminium bush.
- 5 Screw M6 bolt into front of bullet moulding hand tight.

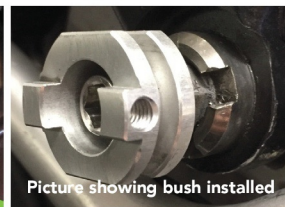

PADDOCK STAND / BOBBIN SET
PART NO. BA12-8-GBR-SET

- 1 Assemble M8 x 40mm Bolt through the moulded bobbin.
- 2 Tighten bolts to swing arm boss, 8 Nm.
DO NOT OVERTIGHTEN



LOWER CHAIN GUARD
PART NO. CGA09-GBR

- 1 Assemble 2 off M6 x 20mm bolts and washers through the moulded lower chain guard into the Black Anodised aluminium mounting block CGA09-2.
- 2 Position the assembly underneath the swing arm, closing the gap to the rear sprocket.
Note : There should be a 5mm minimum gap from the bike chain to the lower chain guard.
- 3 Mark the position of the Black Anodised block, relative to the swing arm.
- 4 Disassemble the assembly, leaving the block to be replaced into the correct position.
Mark the C/Sunk fixing hole positions on the underside of the swing arm.
- 5 Drill & Tap the marked holes , M6 - (Drill 5mm Dia. for tapping)

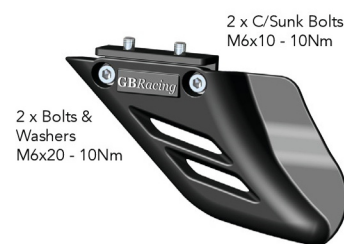

THIS SHEET INCLUDES FITTING INSTRUCTIONS FOR THE FOLLOWING PARTS:

Secondary Alternator Cover Part No. EC-ZX10-2011-1-GBR / Secondary Clutch Cover Part No. EC-ZX10-2011-2-GBR /
Secondary Pulse Cover Part No. EC-ZX10-2011-3-GBR / Bullet Frame Race Slider Set - STREET - Part No. FS-ZX10-2011-S /
Bullet Frame Race Slider Set - RACE - Part No. FS-ZX10-2011-R / Bobbin Set Part No. BA12-8-GBR-SET /
Lower Chain Guard Part No. CGA09-GBR / Lower Chain Guard Part No. CGA29-GBR



SECONDARY ALTERNATOR COVER
PART NO. EC-ZX10-2011-1-GBR

1. Remove Lower Fairing panel.
2. Remove 4 existing bolts from the stock Alternator cover, shown as position Bolt 1, 2, 3 & 4.
3. Place the Secondary Alternator Cover over the stock cover.
4. Assemble 4 replacement bolts loosely in the correct position as shown.
5. Tighten bolts to a Torque of 11Nm as per manufacturer's recommendations.
DO NOT OVERTIGHTEN.
6. Re-Fit Lower Fairing Panel.

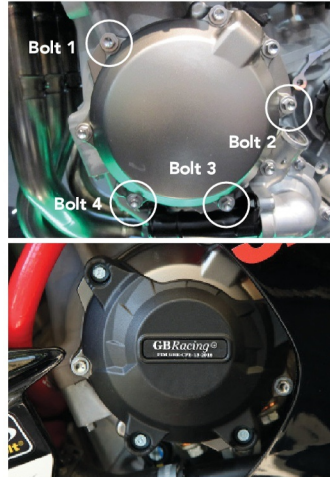

Bolt 1
M6x35 - 11Nm

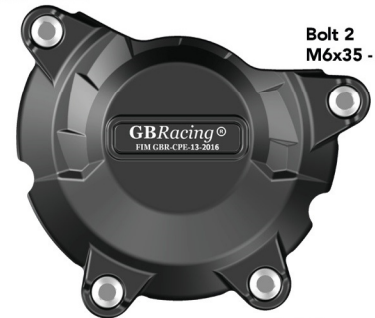

Bolt 2
M6x35 - 11Nm

Bolt 4
M6x35 - 11Nm

Bolt 3
M6x35 - 11Nm

SECONDARY CLUTCH COVER
PART NO. EC-ZX10-2011-2-GBR

1. Remove Lower Fairing panel.
2. Remove 3 existing bolts from the Clutch cover, shown as position Bolt 1, 2 & 3.
3. Place the Secondary Clutch Cover over the stock cover.
4. Assemble 3 replacement bolts loosely in the correct position as shown.
5. Tighten bolts to a Torque of 11Nm as per manufacturer's recommendations.
DO NOT OVERTIGHTEN.
6. Re-Fit Lower Fairing panel.

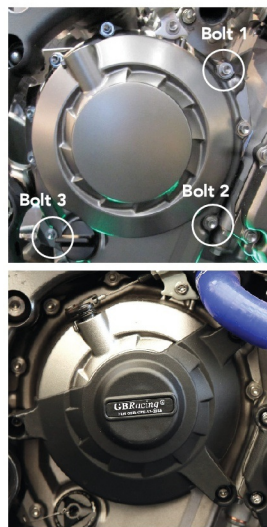

Bolt 1
M6x35 - 11Nm



Bolt 3
M6x35 - 11Nm

Bolt 2
M6x35 - 11Nm

SECONDARY PULSE COVER
PART NO. EC-ZX10-2011-3-GBR

1. Remove 3 existing bolts from the Pulse cover, shown as position Bolt 1, 2 & 3.
2. Place the Secondary Pulse Cover over the stock cover. Assemble 3 replacement bolts loosely in the correct position as shown.
3. Tighten bolts to a Torque of 11Nm as per manufacturer's recommendations.

DO NOT OVERTIGHTEN.

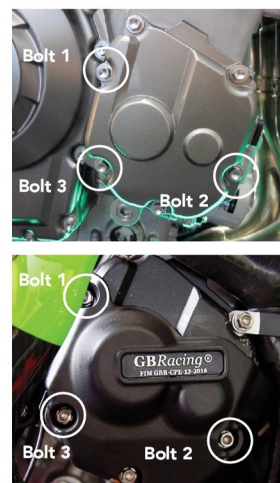

Bolt 1
M6x30 - 11Nm



Bolt 3
M6x30 - 11Nm

Bolt 2
M6x30 - 11Nm